

# AIM™ (Anika Implant Management)

## Image Upload Quick Reference Guide

AIM is a pre-operative planning software offering surgeons a 3D rendering for anatomic and reverse shoulder arthroplasty, with both glenoid and humeral planning capabilities.

### AIM is compatible with Anika shoulder systems:

- OVOMotion® with Inlay Glenoid Total Shoulder Arthroplasty System
- RevoMotion™ Reverse Shoulder Arthroplasty System

### Common Image Rejection Reasons

**Slice Thickness** – Make sure to follow the scan protocol (1.25mm or smaller).

**Slice Increment** – Make sure it overlaps at least 50% or is contiguous.

**Oblique Images** – Oblique images are NOT accepted.

**Metal** – Metal can cause distortion of critical anatomy.

Please refer to the CT Scan Protocol document (AML-900-530) for comprehensive scan requirements..

powered by   
**materialise**

### Anika Therapeutics, Inc.

28 Forge Parkway, Franklin, MA 02038  
1-508-520-3003 | stayactive@anika.com

www.anika.com | Anika. Restore Active Living.™ | Stay Active®  
AIMsupport@anika.com (AIM™ Customer Support) | anikasupport@materialise.com (Manufacturer)

This document and information is intended for markets where regulatory approval has been granted. Anika, AIM, Arthrosurface, OVOMotion, RevoMotion Stay Active, and Restore Active Living are trademarks and/or registered trademarks of Anika Therapeutics, Inc. and its affiliates in certain jurisdictions. System designed and manufactured in the USA | Printed in the USA  
©2023 Anika Therapeutics, Inc. All rights reserved.

AML-900-545 REV 01

## AIM Image Uploading

**Step 1:** Login to your account at: <https://surgicaseoos.materialise.com>  
Contact your local sales representative or AIM Support ([AIMSupport@Anika.com](mailto:AIMSupport@Anika.com)) to request a login or for login assistance.

**Step 2a:** Create a new case (if case already exists – continue to Step 2b)  
Click “Add Case” and complete all required information.



**Step 2b:** If case already exists: Click on the specific case to open the Case Details.  
Note: Only cases that have a status of “Waiting for Data Upload” or “New Data Upload Requested” can have images uploaded.

**Step 3:** Upload DICOM images  
Drag and drop on the screen or upload the patient’s DICOM files from your computer. Once all folders/files are added, click “Start Upload”.

**Important:** Files must be unzipped, extracted or uncompressed to be uploaded. Drag and drop functionality is not compatible while using Internet Explorer. Google Chrome is the recommended browser.

**Step 4:** Check the box “Promote the case automatically on upload complete” or click “Approve” at the bottom of the ACTION CENTER to submit CT images.

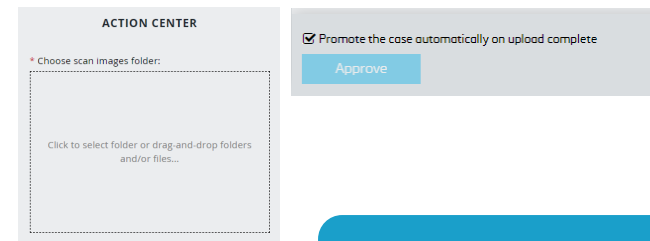

**For questions, please contact  
Materialise Customer Service:**

734-259-6669